

Motor:	MM28
Voltage:	1v - 6v max.
Current:	0.1A - 1.0A (depending on load)
Housing:	Nylon
Gears:	Nylon (with replaceable gear/output shaft)
Lubrication:	Requires light oil or silicon grease

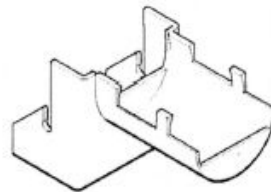

The power unit has been designed so that the output shaft can be 'clicked' in and out for modification - e.g. cutting down to size, force fitting of cams, wheels etc. The motor is snap fitted into its cradle to engage the gear and worm

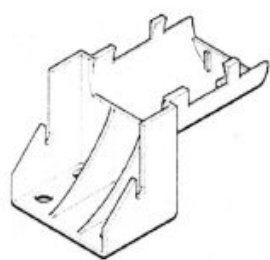

The unit needs lubricating before use between pinion and gear and between the rotating shaft and nylon shell. **If the unit is forced to drive an exceptionally heavy load (or is stalled), the worm pops out of mesh with the gear.** This offers some protection against mechanical overload - but can be overridden by securing the motor in its cradle with a cable tie.

